

# PLAN DE PRE-COMMERCIALISATION

type:  
**T3**

Surface hab: 58.40m<sup>2</sup>

**N° 14**

étage:  
**étage 1**

balcon: 19.36 m<sup>2</sup>

échelle:  
1cm/m



Grenoble le 18 juin 2007

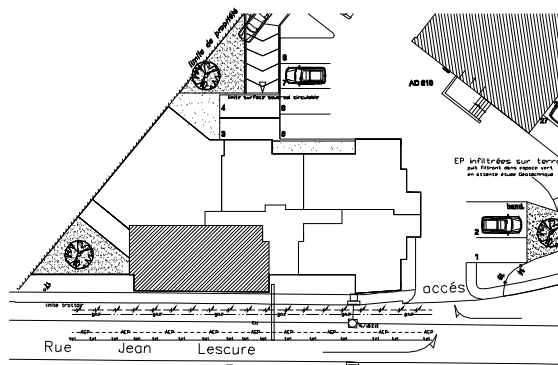
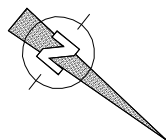
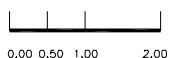
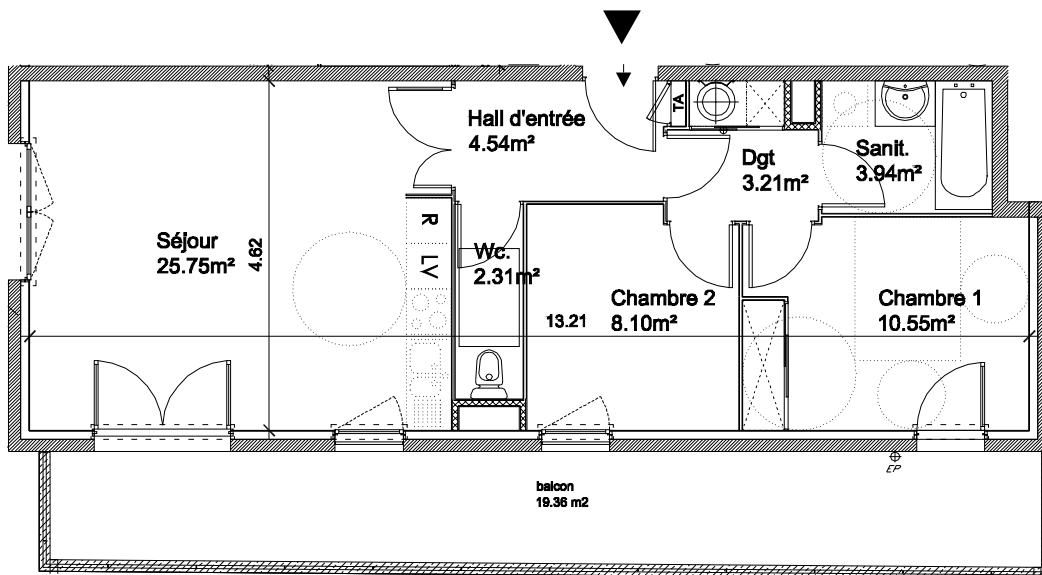

**"Le Victor Hugo"**  
Commune de la **TOUR DU PIN**

**SCI Active 2006**

ZI les marais-BP 56- St jean de soudain  
38352 LA TOUR DU PIN  
tel 04 74 97 45 07  
fax 04 74 97 67 94

